

legend

- BDRY boundary
- BOE brick on edge
- BFB bagged painted brickwork
- CCR1 corrugated roof sheeting (custom orb)
- CCR2 corrugated roof sheeting (trimdeck)
- CF colorbond fascia
- CFC compressed fibre cement
- CONC concrete
- CJ control joint
- CT ceramic tile
- CPT carpet
- CRT concrete roof tile
- COG colorbond quad gutter
- DP downpipe
- DR&S downpipe & spreader
- EGL existing ground line
- EMB electrical meterboard
- FB face brick
- FC fibre cement
- FFL finished floor level
- F fixed glass
- FGL finished ground line
- GM gas meter
- HWS hot water service
- PB plasterboard
- PC1 paint colour 1
- PC2 paint colour 2
- PCR painted cement render
- PFD painted face brick
- PFC painted fibre cement
- PWB painted weatherboard
- RL relative level
- SC solder course
- SD smoke detector
- TC timbercrete
- TFB timber floor boards
- TRC terracotta roof tiles
- VC vinyl cladding
- WM water meter

- b basin
- b/head bulkhead
- dry dryer
- dw dishwasher
- exh exhaust fan
- fr freezer
- fw floor waste
- hr handrail
- lb letterbox
- loh lift off hinges
- m mirror
- mh man hole
- mw microwave
- orh overhead
- p pantry
- ref refrigerator
- rh rangehood
- sh soap holder
- ss stainless steel sink
- st stove
- shwr shower
- t tub
- tgsl tactile indicator
- top top of wall
- tr towel rail
- trh toilet role holder
- typ. typical
- wc water closet
- wm washing machine
- v vent pipe
- vp vent pipe
- uo under bench oven
- wo wall oven

existing and unchanged

notes

1. tracks to sliding and folding door suites shall be recessed into floor structure and finish flush with adjacent floor surfaces
2. tiled floor areas shall finish flush with adjacent floor surfaces
3. portable fire extinguishers shall be selected, located and distributed in accordance with Sections 1, 2, 3 and 4 of AS2444
4. smoke detectors must be installed in accordance with AS1670.1
5. HMS shall be instantaneous gas type installed in Smartbox recess box with semi-recess frame and cover (Rimal or equivalent)
6. proposed lightweight external walls shown with a solid grey hatch shall achieve an FRL not less than 60/60/60
7. where an external wall requires a FRL, any eave, soffit or projection beyond that wall shall have the same FRL
8. ramp and deck shall have a slip resistant finish (R11 min.)
9. external walls shall be insulated to achieve a minimum total R-value of 1.8
10. floors shall be insulated to achieve a minimum total R-value of 1.5
11. air conditioning shall comply with BCA Part J5
12. new artificial lighting shall comply with BCA Part J6



copyright integratedDESIGNgroup p/l abn 21 995 789 058
nominated architects
tony mcburney reg. no. 5273 | simon thorne reg. no. 7093
figured dimensions take precedence over scaled drawings |
contractors to check and verify all levels datum and dimensions on site |
all materials and workmanship to be in accordance with current written manufacturers | instructions local regulations and SAA codes |
conflicting information to be brought to notice of the architect and clarification sought before proceeding with any works

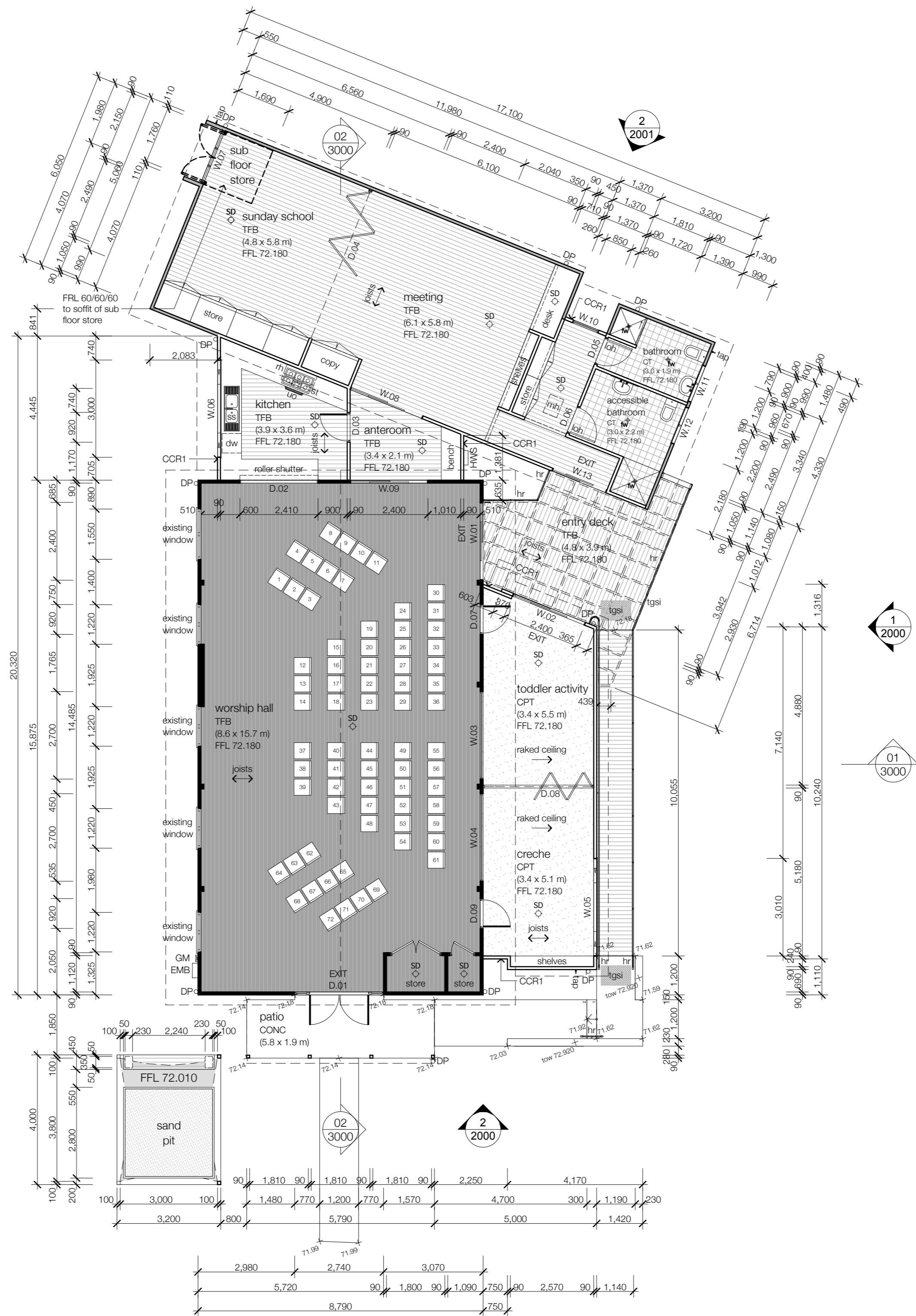

preliminary
not for
construction

06/11/09 a issued for combined da | cc
date issue amendments

ground floor plan

church facility
alterations and additions
becp | heffron rd | lalor park

date: 23 | 01 | 09
drawn: pt | sl | tq
checked: amcb
scale: 1:100 @ a2
0 1 2 3 5m
issue a